

$\phi 4 \frac{3}{4}"$
Swivel Top

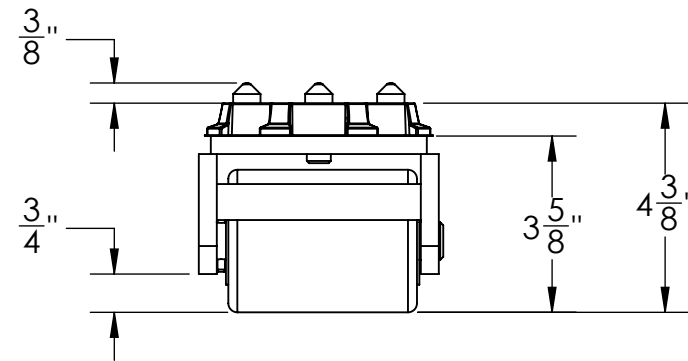
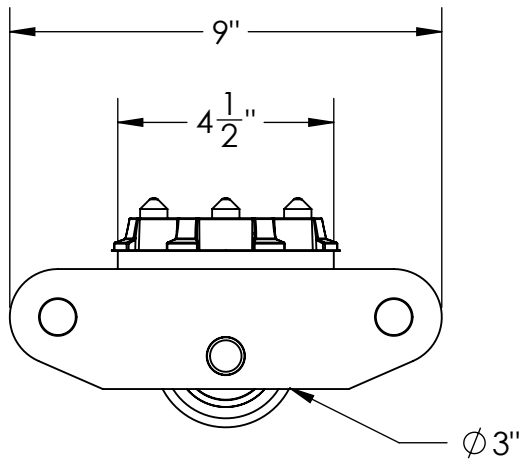
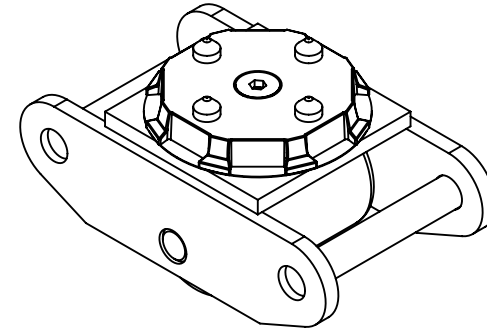
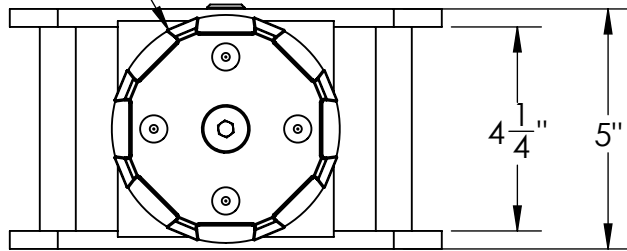

Approval Print
Cherry's Industrial Equipment
Date Sent: _____

- ☐ APPROVED. PROCEED WITH FABRICATION
- ☐ APPROVED AS NOTED. PROCEED WITH FABRICATION. FURNISH REVISED PRINTS
- ☐ REVISE AS NOTED. RE-SUBMIT FOR APPROVAL. DO NOT FABRICATE.

Tolerances Unless Otherwise Specified
Decimals: 0.X = +/- 0.1
0.XXX = +/- 0.01
0.XXX = +/- 0.005
Angle: +/- 1
Fraction: +/- 1/4

This drawing is confidential and is supplied on the express condition that it is not copied or communicated to other persons or companies.
Do not scale - If in doubt, ask.
Please inform if modifications are made during manufacture.

Third Angle Projection
All Units in Inches

X	X/X/XXXX	XXX
#	Date	By
Drawing Revisions		

Mark 1
Poly Roller Skid

CHERRY'S
INDUSTRIAL EQUIPMENT
600 Morse Ave.
Elk Grove Village, IL 60007

Date:	10/2/2012
Scale:	1:xx
Drawn By:	RJL
Checked By:	RJL
Material:	Steels
Weight:	14 lbs. Aprx.
Drawing #:	RSMK1a